

**MONUMENTING STREET CENTERLINES WHEN SEWERS ARE LOCATED ON CENTERLINE**

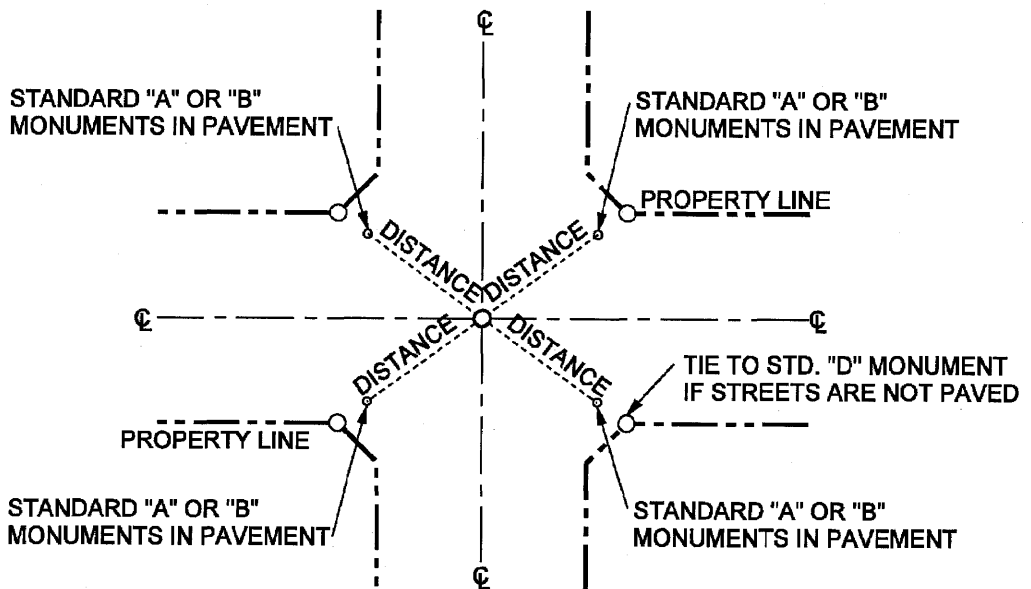

**MONUMENTING STREET CENTERLINES WHERE CURBS ARE NOT REQUIRED**

**NOTES:**

1. L & T AS SHOWN HEREON INDICATES LEAD AND TACK OR STEEL PIN MONUMENT SET IN CURB.
2. LEAD AND TAG OR STEEL PIN MONUMENT WITNESS TO PROPERTY CORNER MAY BE SET, NOT REQUIRED.
3. SEE MONUMENT SPECS 21 FOR TYPE "A, C, D, & E" MONUMENT DESCRIPTION AND STD. 903 FOR TYPE "B" MONUMENT DRAWING. SEE SPECS 21.07 FOR MONUMENT SCHEDULE.

R.C.T.D. STD. No. 900

**REVISIONS:**

APPROVED 08/21/01	 <i>City of La Quinta</i>	STANDARD
CHRIS A. VOGT CITY ENGINEER RCE 44250		800
<b>TIE-OUT STANDARDS</b>		SHEET 1 OF 1